

swix®



PR0826E

Nordic Ski Preparation

HOW TO WAX FOR SKI-TOURING

swix
swixschool.com

GRIP WAX ZONE



T11 Waxing-cork with sand-paper #100

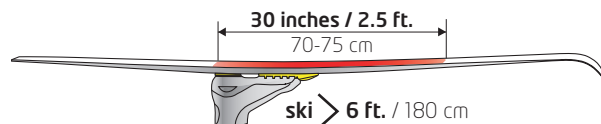

1. Use #100 grit sandpaper, abrade or rough-up the middle third of the ski base, or from the heel of the boot 75 cm (30 inches) and forward. This will give a better bond between the base and the grip wax.
2. Select the appropriate grip wax.
3. Apply 4-5 layers of wax on the sanded area. Cork smooth each layer with a waxing cork. When the temperature is above freezing, 2 layers are enough. When using klister, one layer is sufficient.
4. If your skis are slipping, go to a wax one step warmer (softer).

GLIDE ZONE

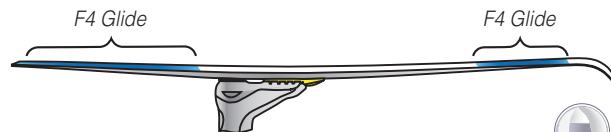

To improve glide, apply F4 Glide wax on the glide zones. Cork the wax into the base for further longevity. Remember: Do not use glide wax in the grip wax zone.



F4-60
Solid Glide



F4-150
Liquid Glide

CLEANING OF SKIS



1. Remove as much hardwax or klister, utilizing a scraper.
2. Apply the Base cleaner and wait a minute.
3. Wipe clean with Swix Fiberlene Paper.



T151



162

GRIP WAX: HARDWAXES



New fallen snow



Old fine grained snow

Advice:

To secure good grip at a given temperature wax softer when older, fine grained snow than for new, fresh snow.

V40 BLUE EXTRA



-1°C to -7°C
(30°F to 19°F)



-3°C to -10°C
(27°F to 12°F)



A wide range wax for normal winter conditions.

V50 VIOLET



0°C to -1°C
(32°F to 30°F)



-1°C to -3°C
(30°F to 27°F)



For conditions around freezing. If Blue Extra becomes slippery, a thin layer of Violet on top is the right wax.

V60 RED/SILVER



+3°C to 0°C
(38°F to 32°F)



+1°C to -1°C
(34°F to 30°F)



For wet and moist snow. Thicker layers when wet. One or two layers are enough.

Hardwax Application:

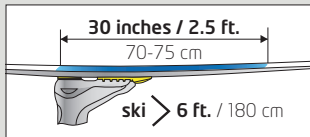

Apply 75 cm (30 inches) from the heel and forward.

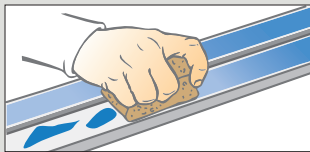

Apply 4 or 5 layers and smooth out using a waxing cork between each layer. Use enough pressure to generate frictional heat to smooth the wax.

GRIP WAX: KLISTERES



Wet corn snow



Frozen corn snow

Klisteres Application:

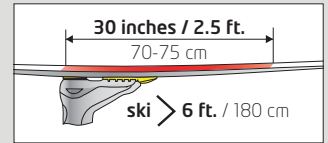

Apply 75 cm (30 inches) from the heel and forward.

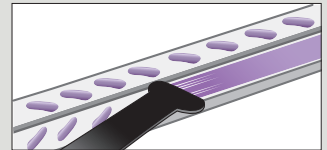
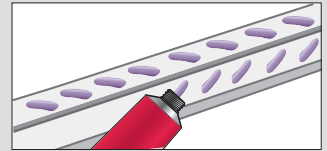

Use the scraper to spread the klisteres to an even layer. One layer is enough.



The applicator makes it easy.



K22N Universal Klister

+10°C to -3°C
(50°F to 27°F)

For coarse, granular snow changing from wet to crust. A very popular and "flexible" klister.



K65 Universal Quick klister

-5°C to +10°C
(23°F to 50°F)

The solution for fast and simple application of klister. Let the klister dry for some minutes before you start skiing.

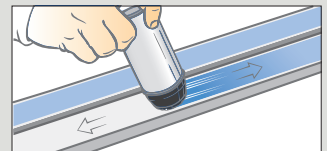
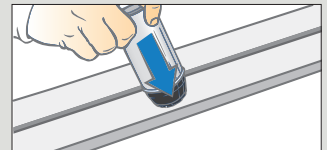

Remark: The temperatures given on the packages refer to air temperatures, measured in the shadow.